

**DESCRIZIONE - DESCRIPTION**

Rubinetto sotto-lavabo ad angolo a sfera in ottone stampato, cromato lucido senza calotta.

Under washer-basin angle ball valve made of forged brass, chromium plated

**CARATTERISTICHE - FEATURES**

- corpo, sfera, asta in ottone CW617N.
- sfera lavorata con utensile in diamante, cromata.
- sedi in P.T.F.E. vergine
- guarnizione tenuta asta: O-ring gomma NBR
- maniglia in ABS cromato
- rosone in acciaio inox
- filettature ISO 228/1
- PN 10: TEMP. : -10°C ÷ 90°C
- brass CW617N body, ball, and stem.
- ball ground by diamond-tipped tool, chromium plated.
- virgin P.T.F.E. seats
- o-ring stem packing in NBR rubber.
- ABS handle, chromium plated
- Stainless steel base ring
- threading to ISO 228/1.
- PN 10: TEMP. : -10°C ÷ 90°C

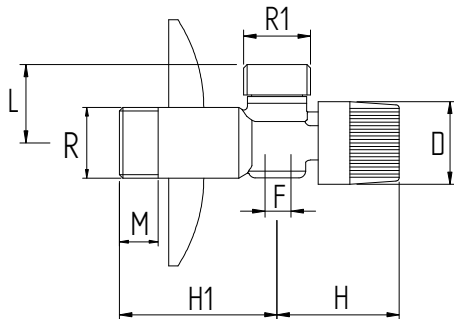
**DIMENSIONI PRINCIPALI - LEADING DIMENSIONS**

RxR1	1/2x3/8	1/2x1/2
F	7	7
L	23	24
H1	45	45
H	35	35
M	14	14
D	24	24