

Valvola ad H termostatzabile con portasonda elettrica, per funzionamento misto.

Angle H valve thermostatic with probe holder electric, for mixed operation.



349TA



349TB



349NN

CARATTERISTICHE - FEATURES

- Corpo calotta e codolo ottone CW617N.
- Componenti interni ottone CW614N
- Volantino in ABS.
- guarnizione tenuta O-ring: EPDM
- finitura: cromataTA, biancaTB, nera NN
- filettature ISO 228/1
- PN 10: TEMP. : -20°C ÷ 100°C
- *brass CW617N body, tail and nut.*
- *Brass CW614N internal components.*
- *ABS cap*
- *Sealing gasket O-ring: EPDM*
- *Chrome finishing TA, whiteTB, Black NN*
- *threading to ISO 228/1.*
- *PN 10: TEMP. : -20°C ÷ 100°C*

DIMENSIONI PRINCIPALI - LEADING DIMENSIONS

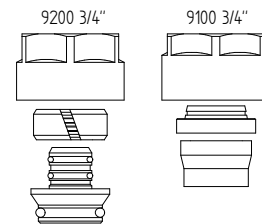
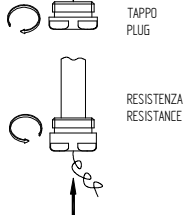
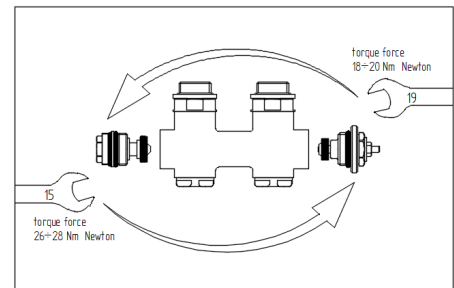
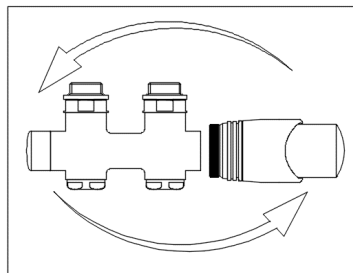
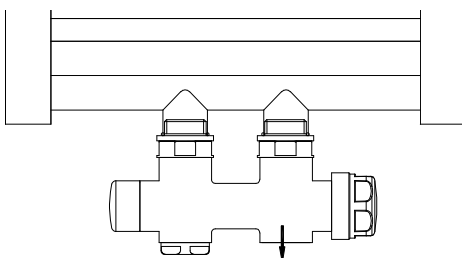
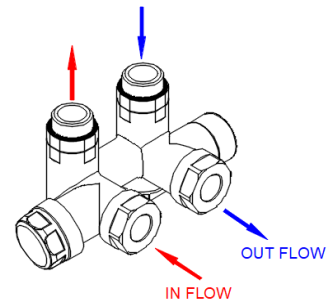
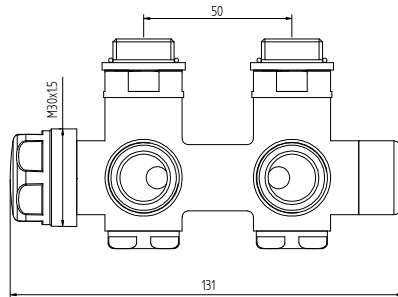
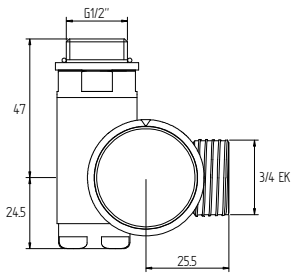

ADATTATORI/FITTINGS

DIAGRAMMA BILANCIAMENTO – BALANCING DIAGRAM

low reduction: close completely the lockshield valve.
 reduce the water flow by the turning the hexagon 6 mm
 spanner towards open. The capacity diagrams show the water
 flow at 1-6 turns and for a fully open valve (Kv).

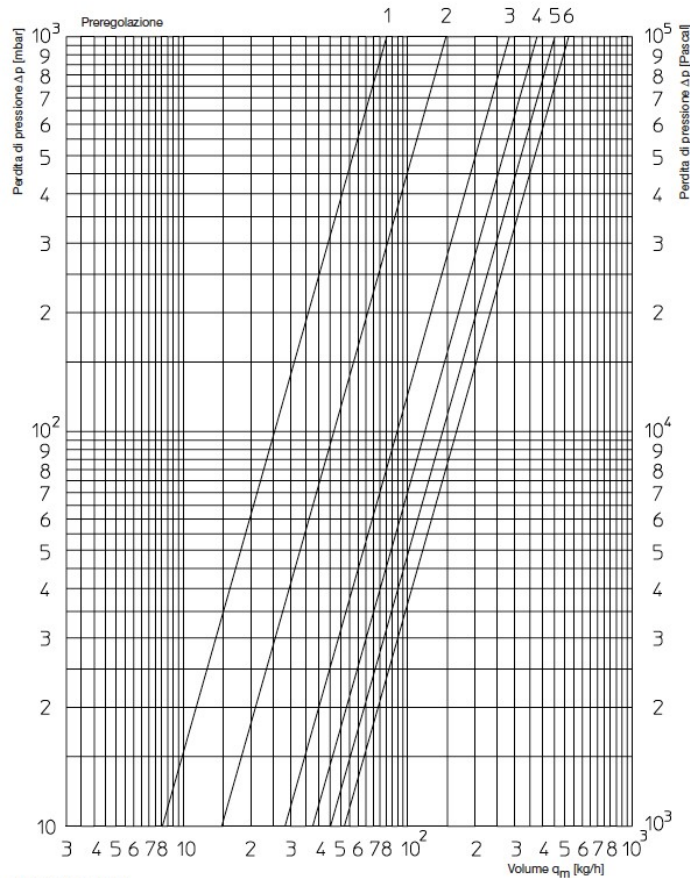
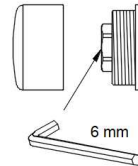
Dati di rendimento:

Preregolazione	1	2	3	4	5	6
Valore kv a 1 K P- scostamento	0,08	0,13	0,20	0,22	0,25	0,28
Valore kv a 1,5 K P- scostamento	0,08	0,15	0,26	0,32	0,37	0,42
Valore kv a 2 K P- scostamento	0,08	0,15	0,28	0,37	0,44	0,52
kvs						0,75