

DESCRIZIONE / DESCRIPTION

Valvola d'arredo quadro attacco a compressione, finitura cromo, bianca e nera.

Angle radiator design valve compression end
Chrome, white and black finishing

Pressione di esercizio 10bar
Working pressure 10 bar

Temperatura di esercizio -20+110°
Working temperature -20+110°

CARATTERISTICHE DELLA VALVOLA

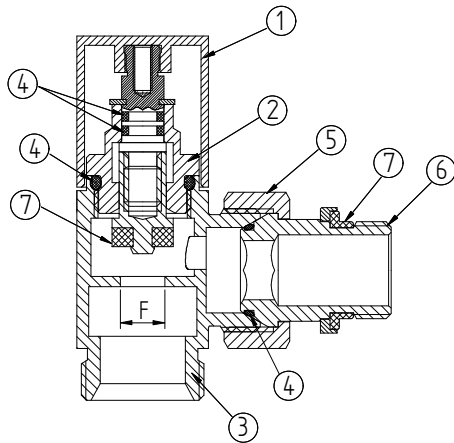

VALVE FEATURES

1: Volantino - handwheel	CW617N
2: Stelo vitone - headwork	CW614N
3: Corpo- body	CW617N
4: O-rings	EPDM
5: Calotta - nut 3/4"	CW617N
6: Bocchettone - tail 1/2"	CW617N
7: Guarnizione - gasket	EPDM

DIMENSIONI PRINCIPALI / LEADING DIMENSIONS

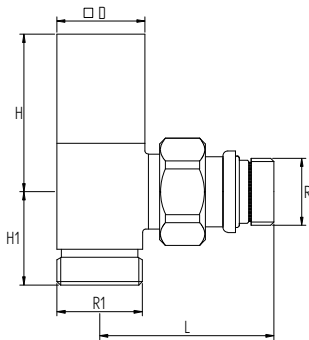

RxR1	1/2x3/4
D	28
L	53
H	50
H1	27

ADATTATORI-FITTINGS

**INSTALLAZIONE REVERSIBILE
REVERSIBLE INSTALLATION**

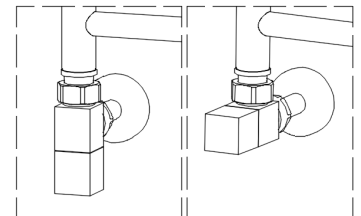
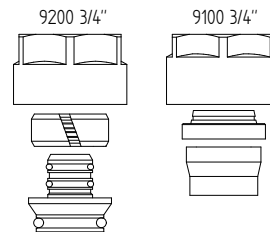

107TA



207TA



107TB
white RAL 9016



207TB



107NN
black RAL 9004



207NN

PERDITE DI CARICO / PRESSURE DROPS

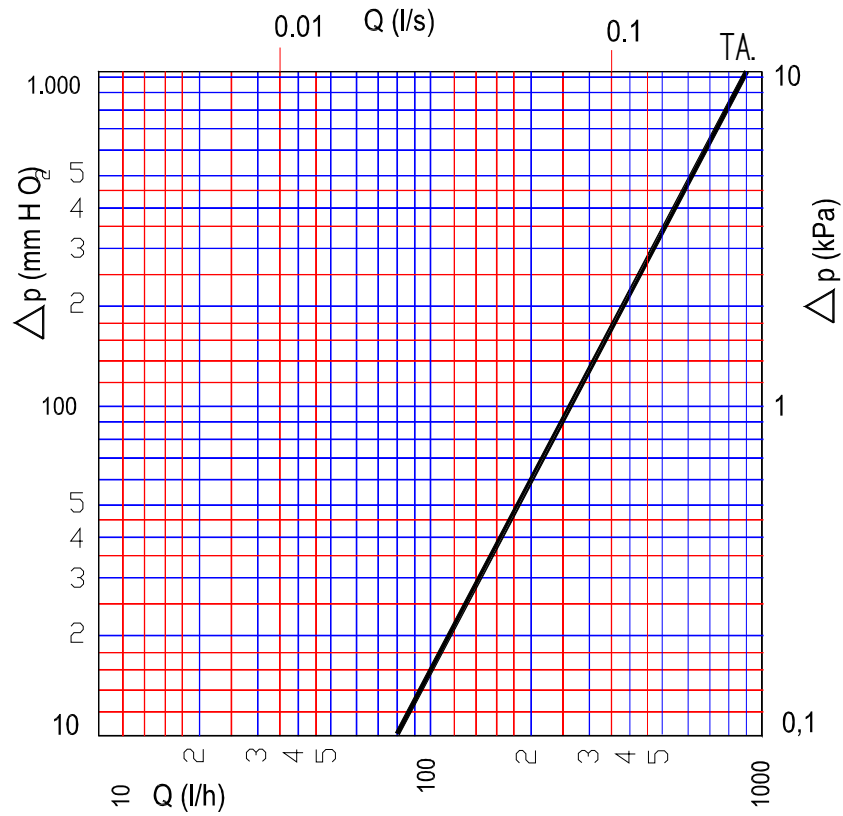

Tutto aperto All open	Kv
T.A	2.9