

DESCRIZIONE / DESCRIPTION

GASTRONG rubinetto a sfera diritto 1/2"
UNI-CIG

*GASTRONG straight gas ball valve 1/2"
UNI-CIG.*

FOTO / PICTURE



3420



3425

CARATTERISTICHE / FEATURES

- corpo, sfera, e asta in ottone.
 - sfera lavorata con utensile in diamante, cromata.
 - sedi in P.T.F.E. vergine dimensionate con angolo di tenuta di 8° min.
 - guarnizione tenuta asta: o-r in gomma NBR
 - finitura superficiale sabbiata cromata
 - 6 bar - 80°C; press. Minima 0.5 bar
- *brass body, ball, stem.*
 - *ball ground by diamond-tipped tool, chromium plated.*
 - *virgin P.T.F.E. seats with 8° min. tightness angle.*
 - *o-ring stem packing in NBR rubber.*
 - *matt chrome finishing.*
 - *6 bar – 80°C; min. pres. 0.5 bar*

DIMENSIONI PRINCIPALI / LEADING DIMENSIONS

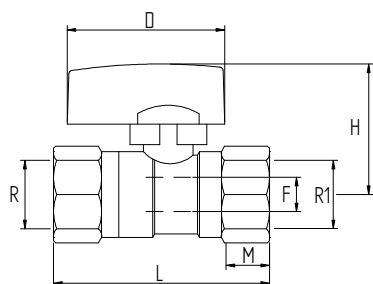
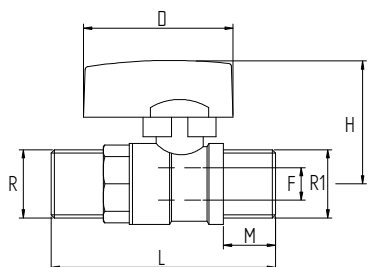

	3420	3425
RxR1	1/2x1/2	1/2x1/2
D	46	46
F	10	10
H	38	38
L	67	63
M	15	15