

DESCRIZIONE - DESCRIPTION

Raccordo diritto/curvo 3pezzi F/M

Three pieces straight/elbow F/M

CARATTERISTICHE - FEATURES

- corpo, raccordo e bocchettone in ottone
- guarnizione tenuta: O-ring in gomma NBR
- finitura superficiale sabbata nichelata
- filettature ISO 228/1
- TEMP. : -20°C ÷ 120°C
- *brass body, nut and tail.*
- *O-ring packing in NBR rubber*
- *matt nickel plated finishing.*
- *threading to ISO 228/1.*
- *TEMP. : -20°C ÷ 120°C*

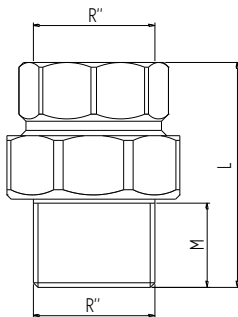
DIMENSIONI PRINCIPALI - LEADING DIMENSIONS

9550

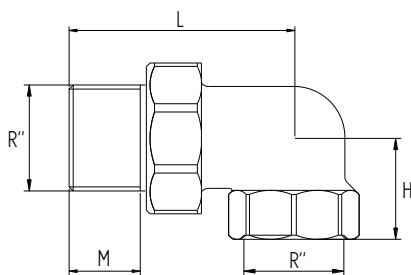
R	1/2	3/4	1	1 ¼	1 ½	2
L	42.5	47.5	50.5	61.5	68	67
M	12	14	14	15	16	17

9560

R	1/2	3/4	1	1 ¼	1 ½	2
L	50	58	62	77.5	87	95
M	12	14	14	15	16	17
H	23	34	37.5	45	50	60