

DESCRIZIONE / DESCRIPTION

Valvola a sfera "pesante" a passaggio totale M/F con leva in alluminio T, e in acciaio ST.

Full way heavy duty ball valve M/F with flat steel lever and aluminium T handle

FOTO / PICTURE



1220STN

1220TN

CARATTERISTICHE / FEATURES

- corpo, sfera, asta e premistoppa in ottone CW617N.
- sfera lavorata con utensile in diamante, cromata.
- sedi in P.T.F.E. vergine dimensionate con angolo di tenuta di 7° min.
- guarnizione tenuta asta: doppio o-r in gomma NBR e anello in PTFE.
- leva di comando in alluminio plastificato con resina epossidica (T) leva in acciaio plastificato (ST).
- finitura superficiale sabbata nichelata, filettature gialle
- filettature ISO 7/1
- PN 40, max. temp. -20°+130°C
- brass CW617N body, ball, stem & stuffing box.
- ball ground by diamond-tipped tool, chromium plated.
- virgin P.T.F.E. seats with 7° min. tightness angle.
- stem tightness: double NBR rubber o-ring and PTFE ring.
- aluminium lever with epossidic coating (T), steel lever with plastic coating (ST).
- Nickel plated finishing with yellow threads.
- threading to ISO 7/1.
- PN 40, max. temp. -20°+ 130°C

DIMENSIONI PRINCIPALI / LEADING DIMENSIONS

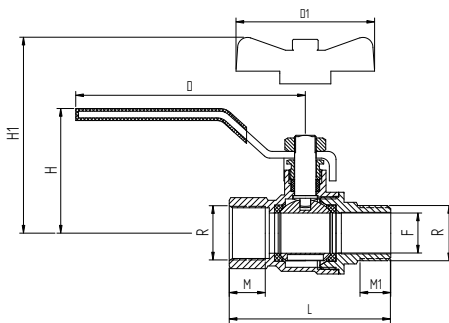

R	1/2	3/4	1	1 ¼	1 ½	2
D	85	85	114	114	142	142
D1	54	54	70	-	-	-
H1	37.5	40.5	51	-	-	-
H	51	54	62	76	81	89
L	66	74.5	86.5	101.5	114	136
M	17	20	21	23	23.5	26
M1	17	20	21	23	23.5	26
F	15	20	25	32	40	50

PRESSIONI DI ESERCIZIO A MAX 80°C / WORKING PREASSURES AT 80°C

PN 40	*	*	*	*	*	*	p.s.i. 600
	1/2"	3/4"	1"	1 ¼"	1 ½"	2"	

PERDITE DI CARICO / PRESSURE DROPS

R"	1/2	3/4	1	1 ¼	1 ½	2
Kv	15	30	57,5	94	160	265

$$\Delta P [\text{mm H}_2\text{O}] = 10.000 \times \left[\frac{G [\text{mc/h}]}{Kv} \right]^2$$