

DESCRIZIONE / DESCRIPTION

Valvola a sfera a passaggio totale M/F anti-legionella 008-025 c/premistoppa, leva in acciaio ST, e in alluminio T.

Anti-legionella full way ball valve 008-025 M/F with stuffing box with flat steel lever and aluminium T handle.

*Vanne à boisseau spérique passage intégral
Anti-legionelles 008-025 M/F a/presse étoupe poignée*

FOTO / PICTURE



CARATTERISTICHE / FEATURES

- corpo, maniccotto e sfera in CW617N.
- premistoppa e asta in CW614N.
- sfera lavorata con utensile in diamante, cromata.
- sedi in P.T.F.E. vergine.
- guarnizione tenuta asta: anello in PTFE+O-ring.
- leva di comando in alluminio plastificato con resina epossidica rossa (T) leva in acciaio plastificato rosso (ST).
- finitura superficiale sabbiata nichelata, filettature gialle.
- filettature ISO 228/1
- PN 30, max. temp. -20° +130°C
- brass CW617N body end connection and ball.
- brass CW614N stuffing box and stem.
- ball ground by diamond-tipped tool, chromium plated.
- virgin P.T.F.E. seats.
- stem tightness: PTFE ring+O-ring.
- aluminium lever red (T), steel lever with red plastic coating (ST).
- nickel plated finishing with yellow threads.
- threading to ISO 228/1.
- PN 30, max. temp. -20° + 130°C

DIMENSIONI PRINCIPALI / LEADING DIMENSIONS

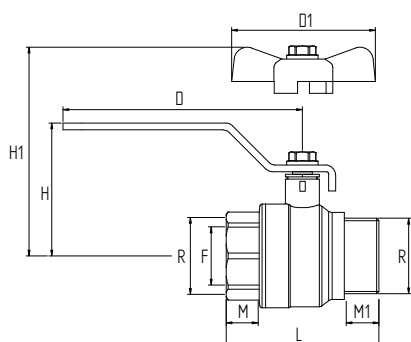

R	1/4	3/8	1/2	3/4	1	1 1/4	1 1/2	2
D	85	85	85	85	114	114	142	142
D1	54	54	54	54	70	70	-	-
H	44	44	48	51	62	70	80	91
H1	37	37	41	44	53	60	-	-
L	45.5	45.5	48	56	65.5	80	91	107
M	11	12	12	12	14	16	17	18.5
M1	11	12	12	12	14	16	17	18.5
F	10	10	15	20	25	32	40	50

PRESSIONI DI ESERCIZIO A MAX 80°C / WORKING PREASSURES AT 80°C

PN 30	*	*	*	*	*	*	*	*	p.s.i. 435
	1/4"	3/8"	1/2"	3/4"	1"	1 1/4"	1 1/2"	2"	

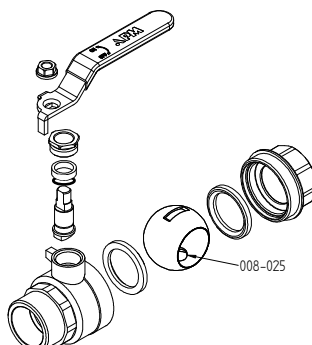

PERDITE DI CARICO / PRESSURE DROPS

R"	1/4	3/8	1/2	3/4	1	1 1/4	1 1/2	2
Kv	9	9	15	30	57.5	94	160	265

$$\Delta P [\text{mm H}_2\text{O}] = 10.000 \times \left[\frac{G [\text{mc/h}]}{Kv} \right]^2$$